

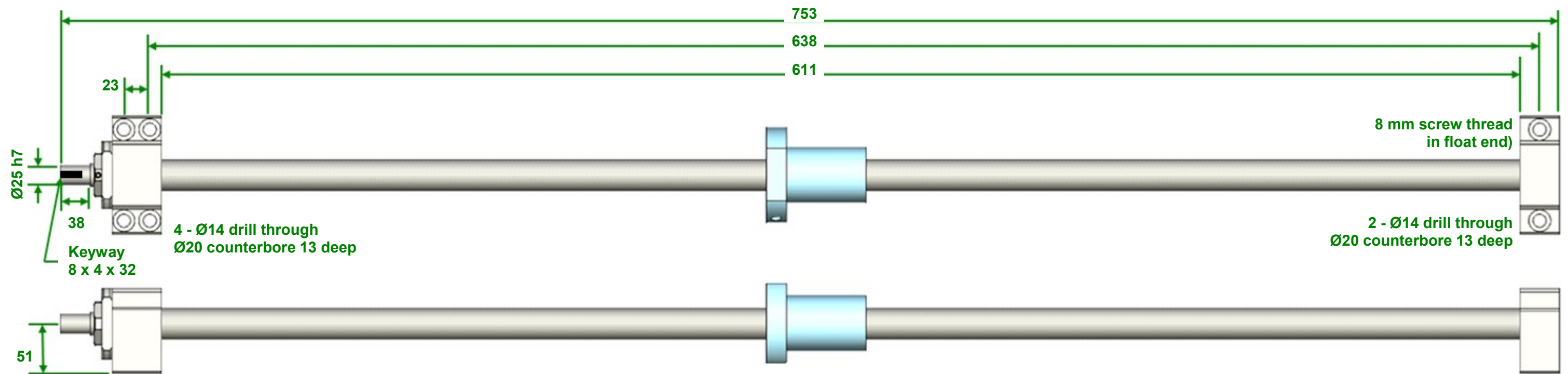

File Name:
F2RFU-4010-0750-BK30-BF30ASM_DATASHEET

Model Code:
F2RFU-4010-0750-BK30/BF30ASM

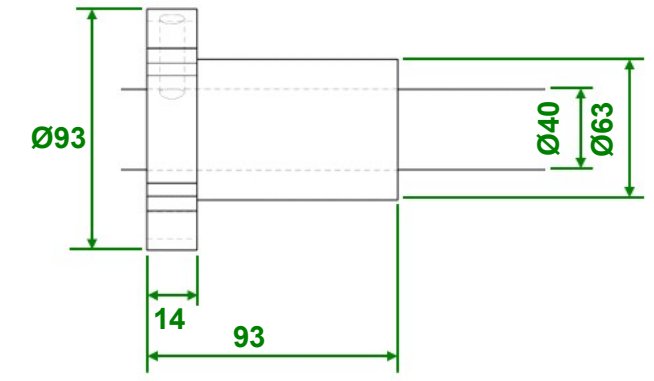
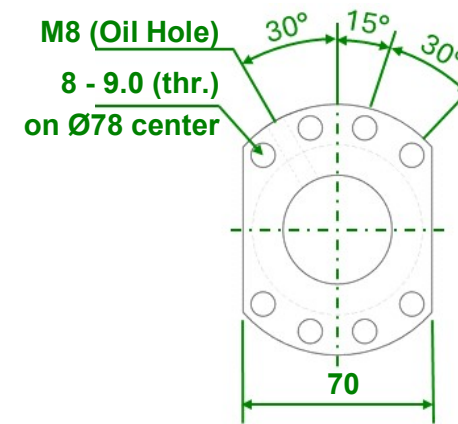

Ball Circle Diameter:	40 mm
Lead:	10 mm
Travel Variation (e300):	±50 µm / 300 mm
Backlash:	0.000 – 0.003
Hand Thread:	Right
C _{dyn} :	8622 lbs (93372 N)
C ₀ :	20992 lbs (38351 N)

Screw Cut Length:	750 mm
Thread Length:	619 mm
Nut Length:	93 mm
Max Stroke:	518 mm

Units: mm

INSPIRE GREAT AUTOMATION



11970 Mayfield Livonia, MI 48150
(248) 798-4877
sales@fang2th.com